

Courses up Juniata River from the Maple to the Locust.

West 22.4
N55W 50
NR8W105

~~177.4~~
177.4

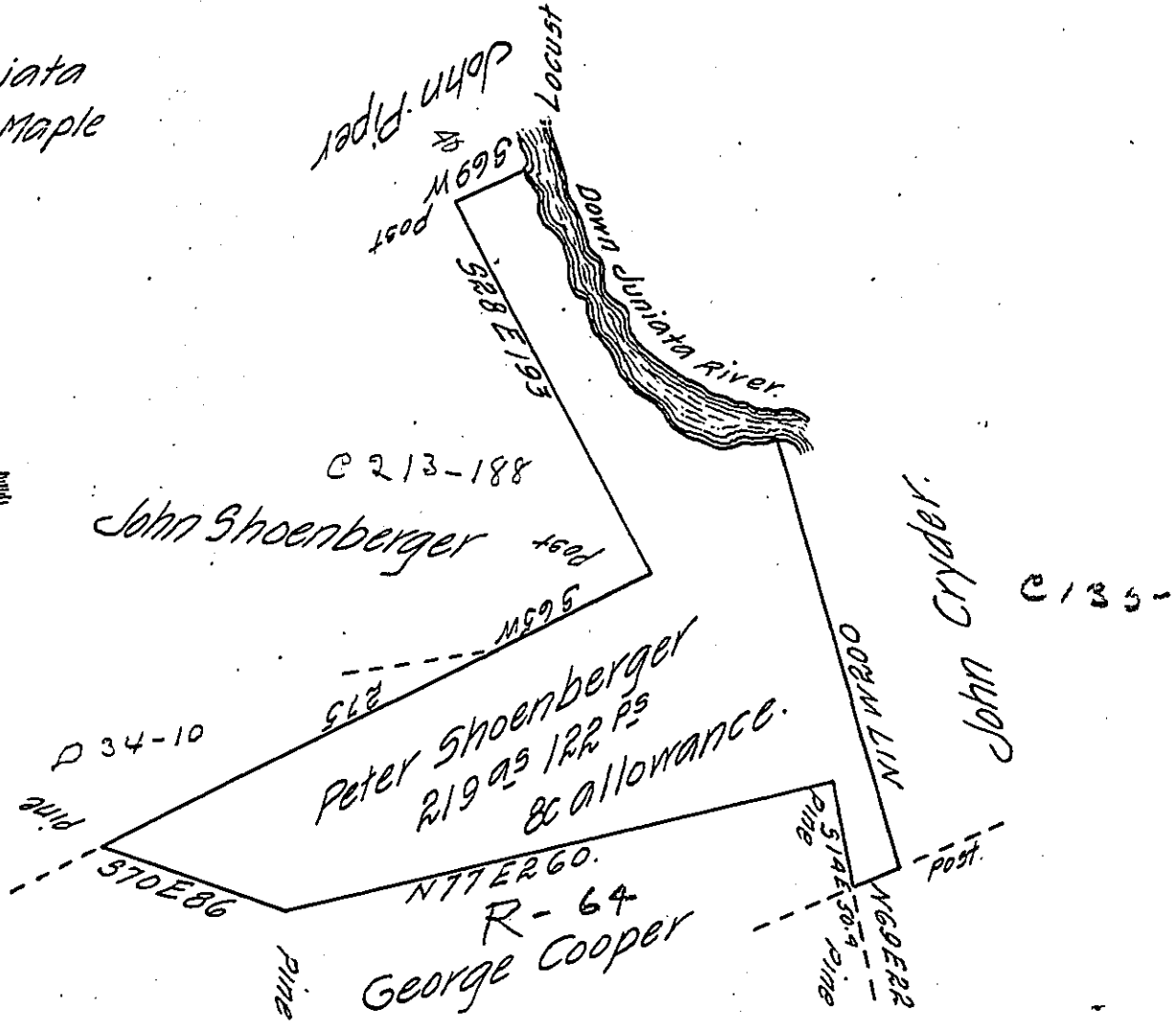

Situate in Porter township Huntingdon County Containing two hundred and nineteen acres 122 perches & allowance surveyed the Ninth Day of August 1814 in pursuance of a warrant granted to Peter Shoenerberger Dated the 21st Day of July 1814.

Richard T. Leech Esq }
Surveyor General }

J^{no} Morrison D.S.

IN TESTIMONY that the above is a copy of the original remaining on file in the Department of Internal Affairs of Pennsylvania, made conformably to an Act of Assembly approved the 16th day of February 1833, I have hereunto set my hand and caused the Seal of said Department to be affixed at Harrisburg, this twenty first day of February 1907.

Isaac P. Brown
Secretary of Internal Affairs.